



Lake Monona
NEW WISCONSIN STATE CAPITOL

AT MADISON

Scale 1/8" = 100'-0"
John Nolen, Landscape Architect
Cincinnati, Ohio
1902

PROPOSED GENERAL PLAN.

MADISON DESIGN PROFESSIONALS WORKGROUP

2016-2017 Nolen Waterfront Contributing Volunteers

TIM ANDERSON

Architect and Urban Planner,
Tim Anderson Consulting, LLC.

ED LINVILLE, AIA

Architect, Founding Principal, Linville Design

DAN WILLIAMS, ALSA

Landscape Architect, Founding Partner,
Lunde Williams, Inc.

DAVID MOLLENHOFF

Madison Historian and City Activist

CAROL RICHARDS, AIA, LEED AP

Architect, Founding Principal, Ross Street Design

MARK SCHMITZ

Experiential Designer, Creative Director, ZEBRADOG

DOUG KOZEL, AIA, LEED AP

Architect, Founding Partner, KEE Architecture

ARLAN KAY, AIA

Architect, Founding Principal,
Architecture Network

FRED KLANCNIK, PE, F. ASCE

Adjunct Professor, UW-Madison Department of
Civil and Environmental Engineering; Founding
Principal, Capstone Engineering Design, LLC

STEVE STEINHOFF, AICP

Planner, Deputy Director, Capital Area Regional
Planning Commission (CARPC)

CONNOR NETT

Landscape Architect, SmithGroupJJR

NOLEN WATERFRONT TECHNICAL ADVISORY COMMITTEE

FRED KLANCNICK, Chair- Nolen Waterfront Technical Advisory Committee

LOEI BADREDDINE, Senior Structural Engineer/ Office Director with GRAEF

CHIN WU, Professor at the UW Department of Civil and Environmental Engineering

MIKE MILLER, Aquatic Ecologist – Wisconsin Department of Natural Resources

MARK O'LEARY, Principal Ecologist with Applied Ecological Services

BOB HANSIS, Hydro Ecologist with Inter-Fluve, formerly Water Resources Supervisor of the South Central Region of the Wisconsin DNR

BILL WUELLNER, Semi-Retired Senior Geotechnical Engineer, CGC, Inc.

BOB JONES, Senior Marine Structural Engineer/ Owner, GKS Engineering

HELEN JOHN, Civil Engineer, NW Technical Advisory Committee Coordinator



TODAY'S PRESENTERS

MARK SCHMITZ

Experiential Designer, Creative Director,
ZEBRADOG

DAVID MOLLENHOFF

Madison Historian and City Activist

DOUG KOZEL, AIA, LEED AP

Architect, Founding Partner, KEE Architecture

FRED KLANCNIK, PE, F. ASCE

Adjunct Professor, UW-Madison Department of
Civil and Environmental Engineering; Founding
Principal, Capstone Engineering Design, LLC



JOHN NOLEN

Madison Visionary

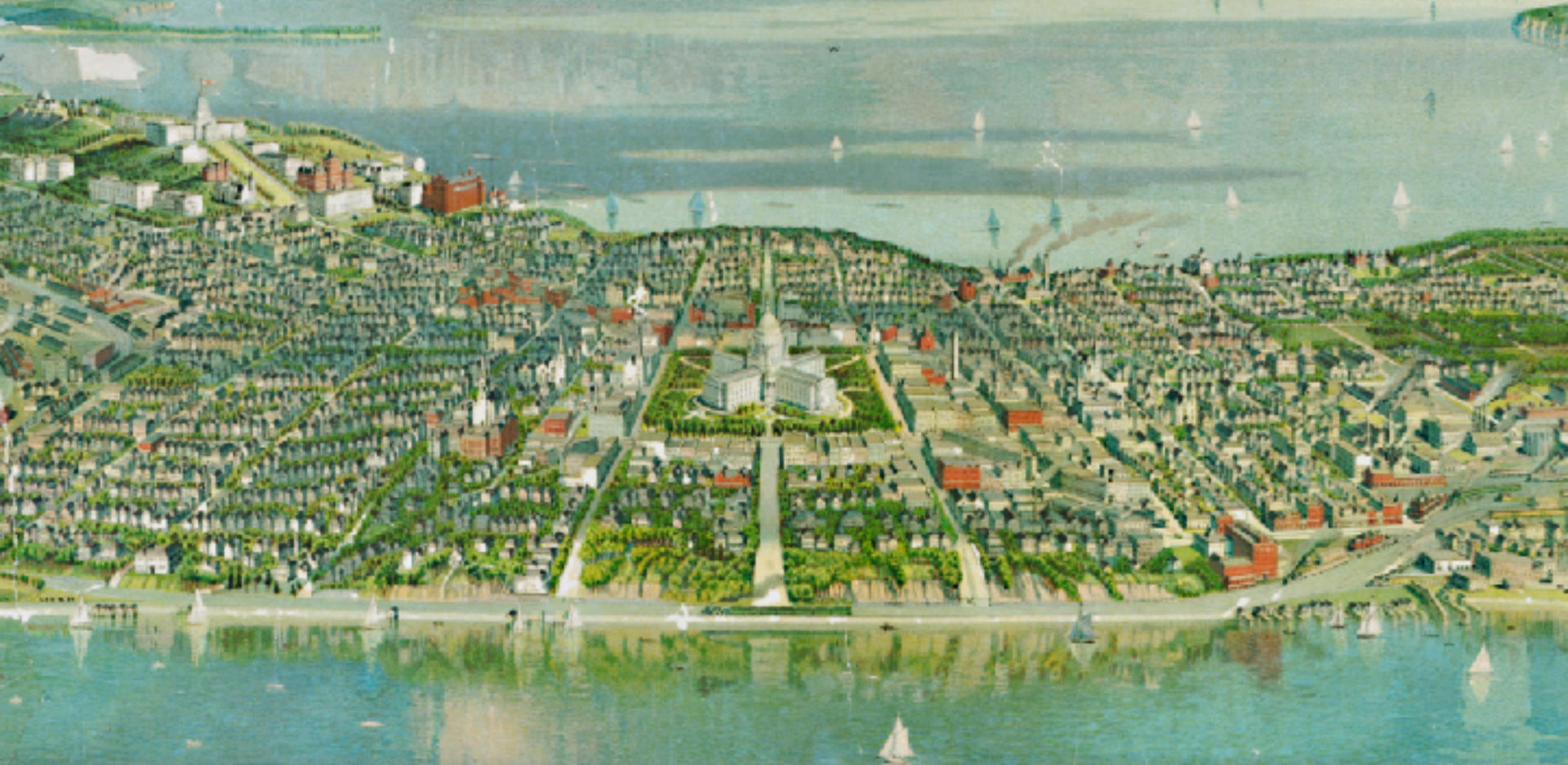



1909 RENDERING BY JOHN NOLEN



2012 Downtown Plan: **RECOMMENDATION #1** **CELEBRATE THE LAKES!**

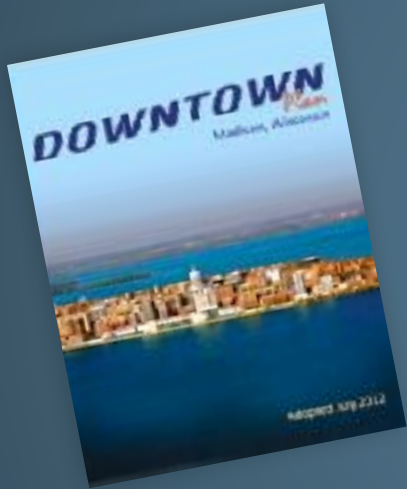

“Transform Law Park to make it a *Signature Park* for the city, including a boathouse or enclosed activity center reflecting a Frank Lloyd Wright inspired design, safe pedestrian and bicycle connections, sustainable practices, transient boat docking, fishing pier, festival grounds, watercraft rentals and similar features.”

QUALITIES OF A SIGNATURE PARK

- Embodies the unique character of the city
- Provides distinctive recreational opportunities for all people
- Creates a major destination for Madisonians and visitors
- Provides high quality public programming
- Increases tourism and generates higher retail sales
- Increases the tax base of nearby properties
- Generates economic growth and civic pride



AN INCLUSIVE VISION



To recapture John Nolen's great vision for Madison's most urban lakefront by transforming an ugly noisy transportation corridor into a beautiful, quiet, accessible, and activity-rich signature park for the people of Madison and visitors.

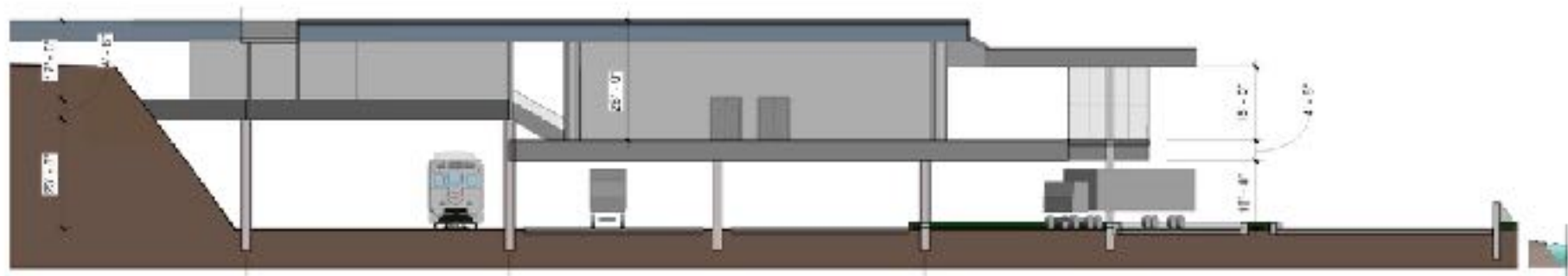



**Convention Center
Expansion**

Boathouse

**Major Park
Expansion**









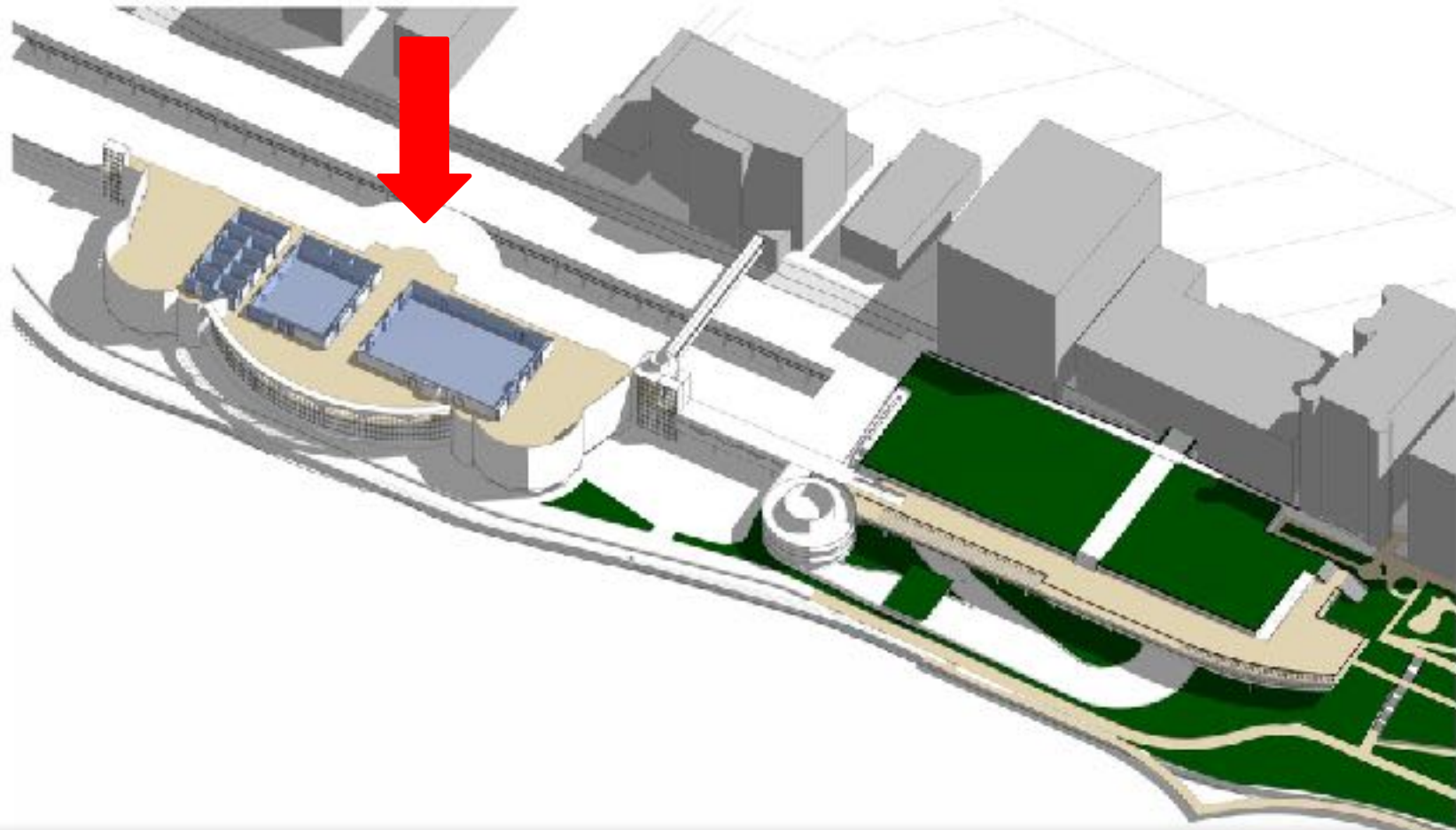

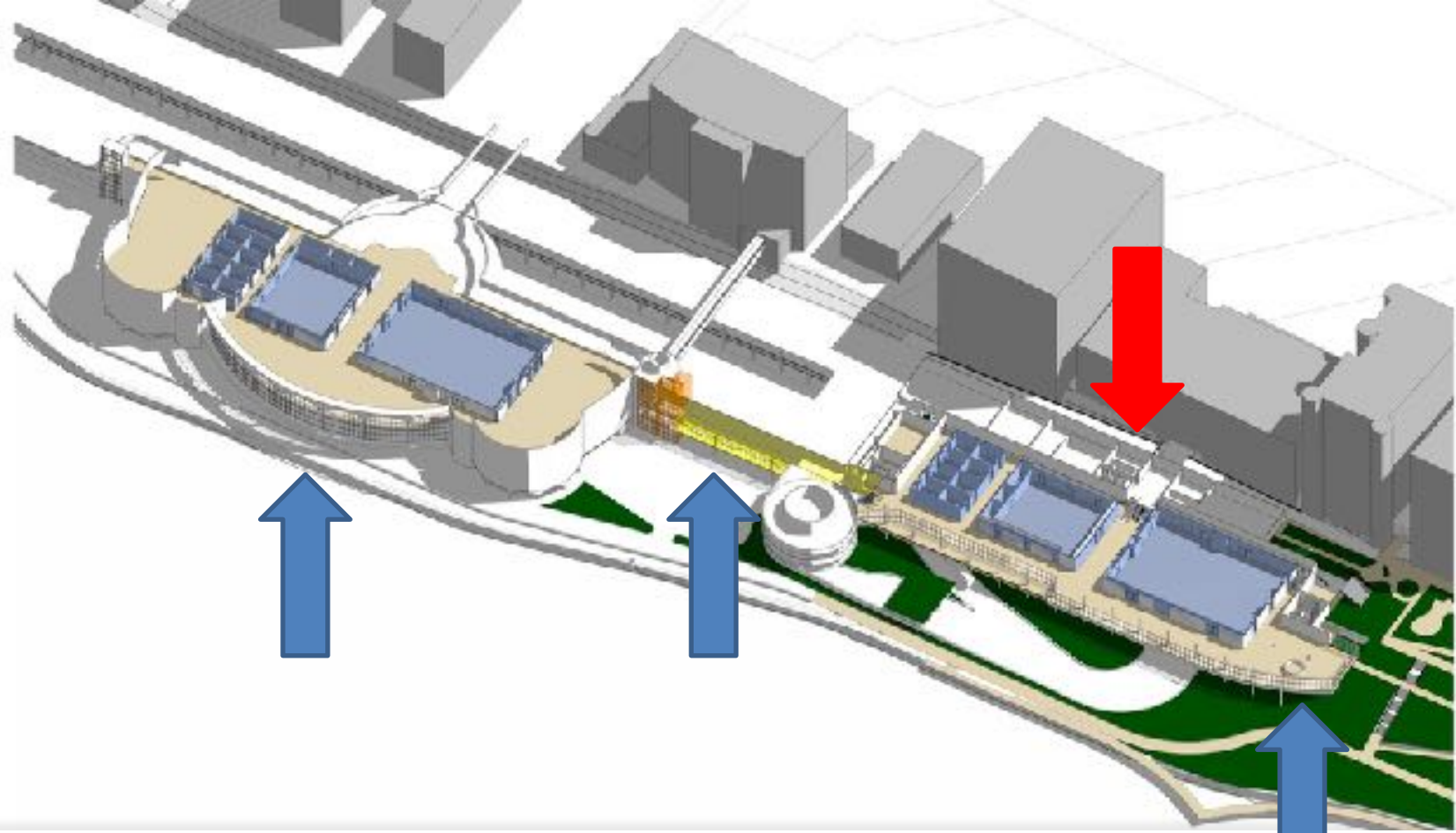





1 Blair Intersection

2 Expand Law Park

3 FLW Boathouse

4 Pedestrian-Bike Bridge

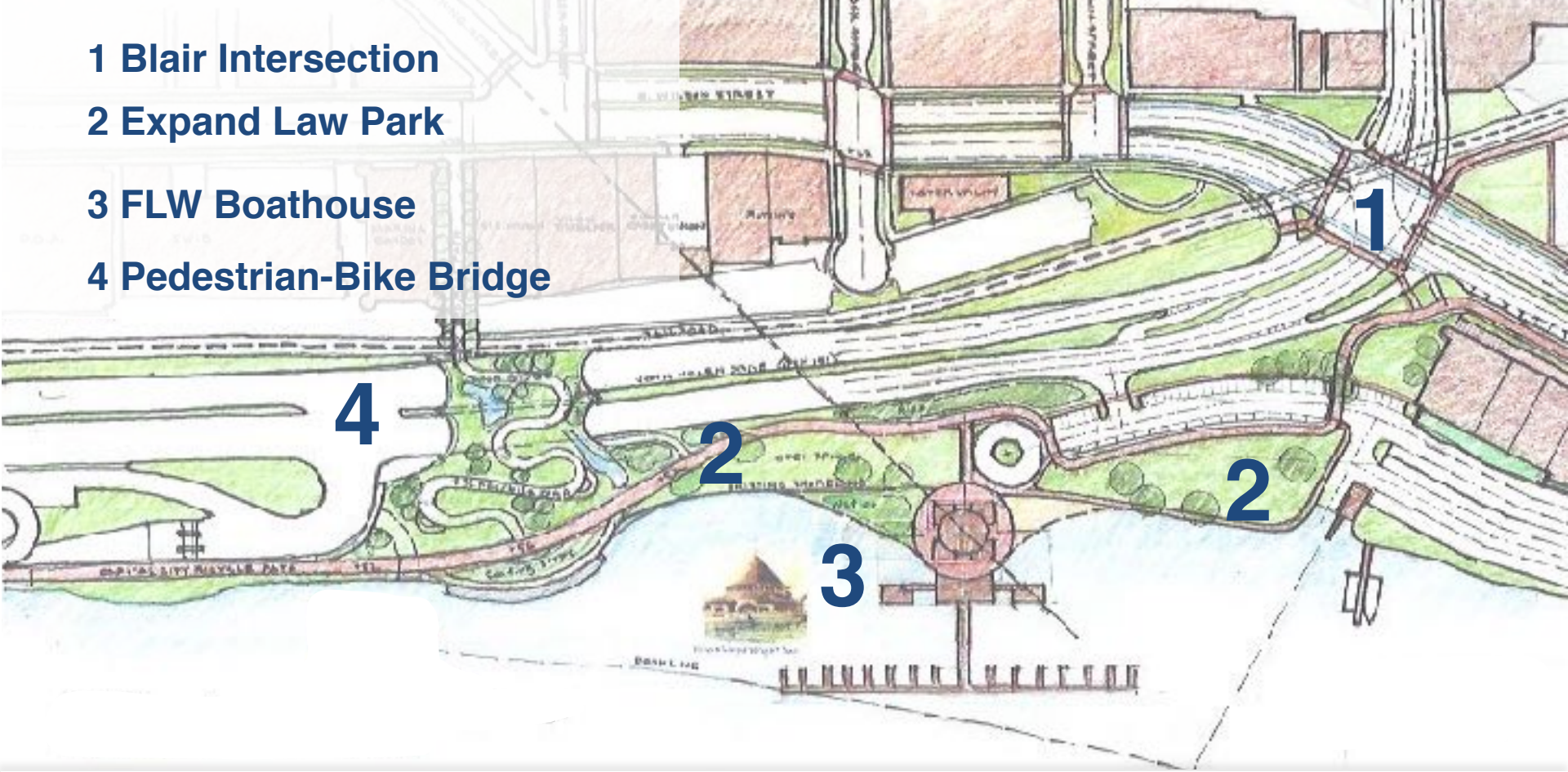

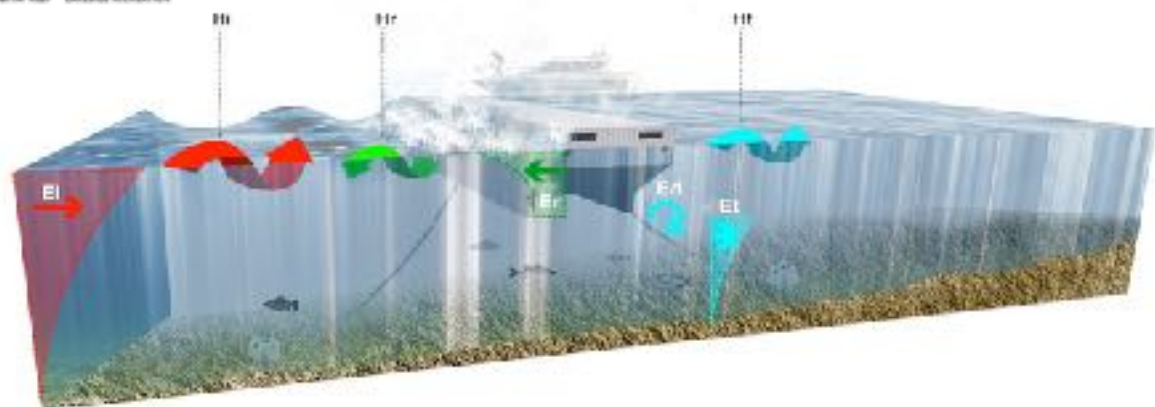
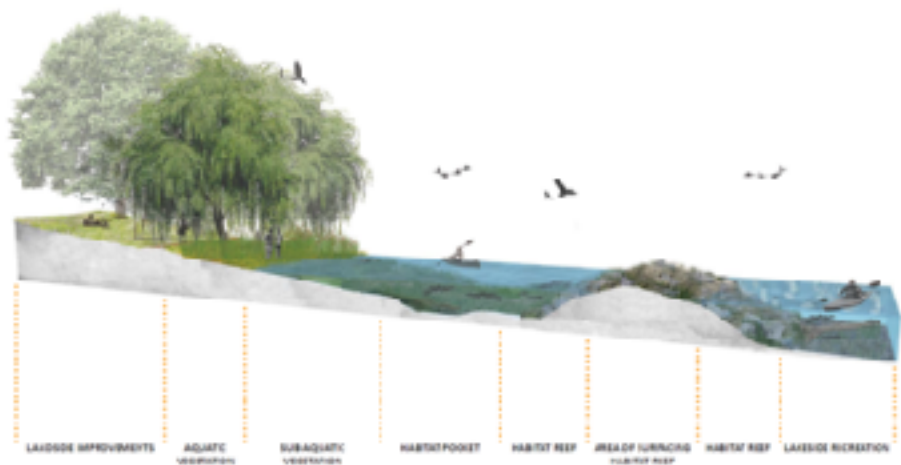

NOLEN WATERFRONT CONCEPTUAL PLANNING TEAMS

TEAM 1

TIM ANDERSON Architect and Urban Planner

ARLAN KAY AIA Architect

CONNOR NETT Landscape Architect, SGJJR

MARGARET BOSHEK Coastal Engineer, SGJJR

TEAM 2

DOUG KOZEL AIA, LEED AP Architect, KEE Architects

DAN WILLIAMS Landscape Architect, Lunde-Williams

STEVE STEINHOFF AICP, Planner, CARP

MILES TRYON-PETITH Shoreland Hydrologist,
Clean Lakes Alliance

TEAM 3

ED LINVILLE, AIA Architect, Linville Design

CAROL RICHARD AIA, LEED AP Architect, Ross Street Design

LARS BARBER Landscape Architect, Baird & Associates

LARRY RYAN P.E. Civil Engineer, Baird & Associates

RODEY BATIZA Geological Engineer, Baird & Associates

HELEN JOHN Civil Engineer, NW TAC Coordinator

1



2



3



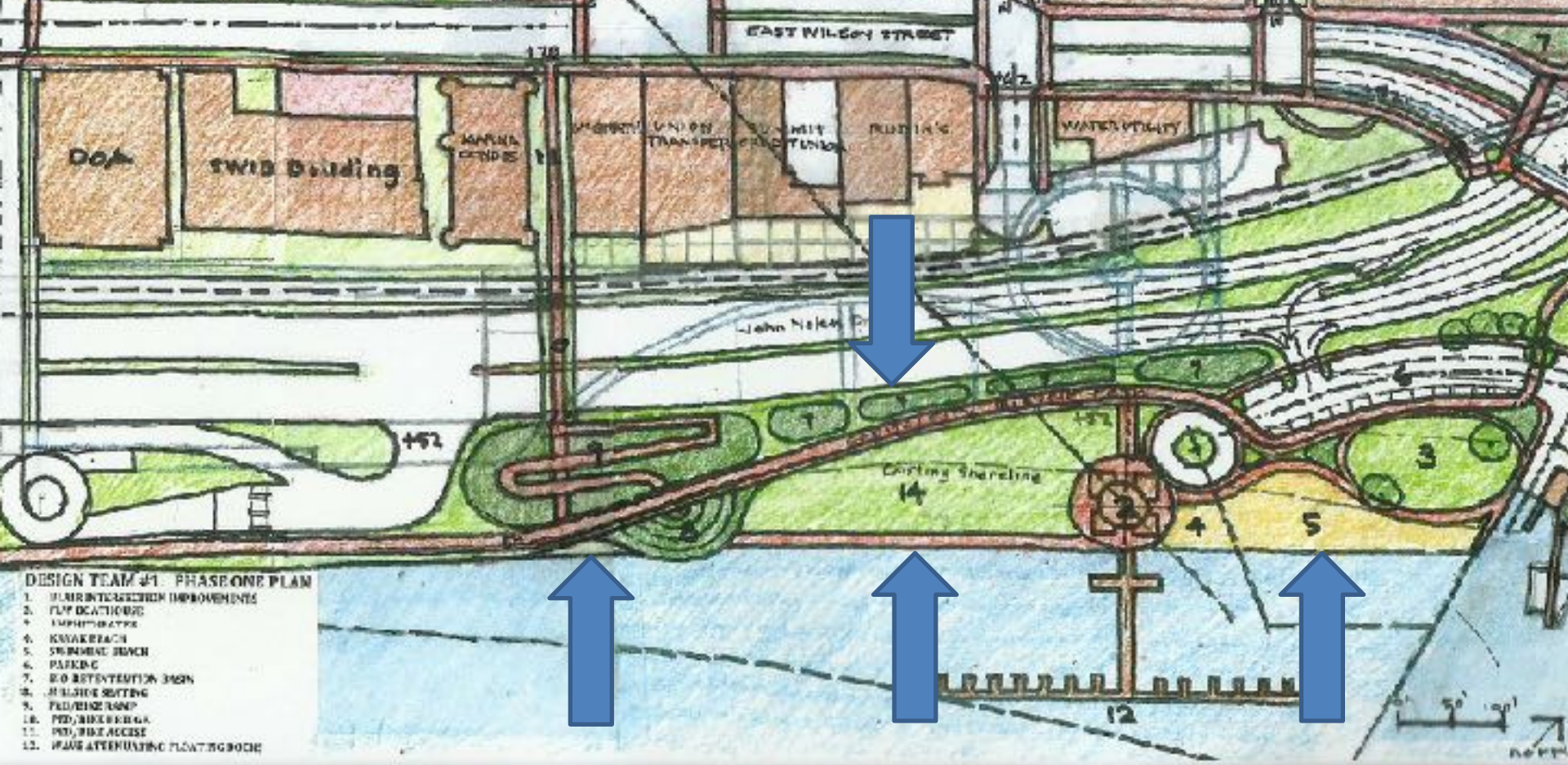

Concept 1 – Phase 1

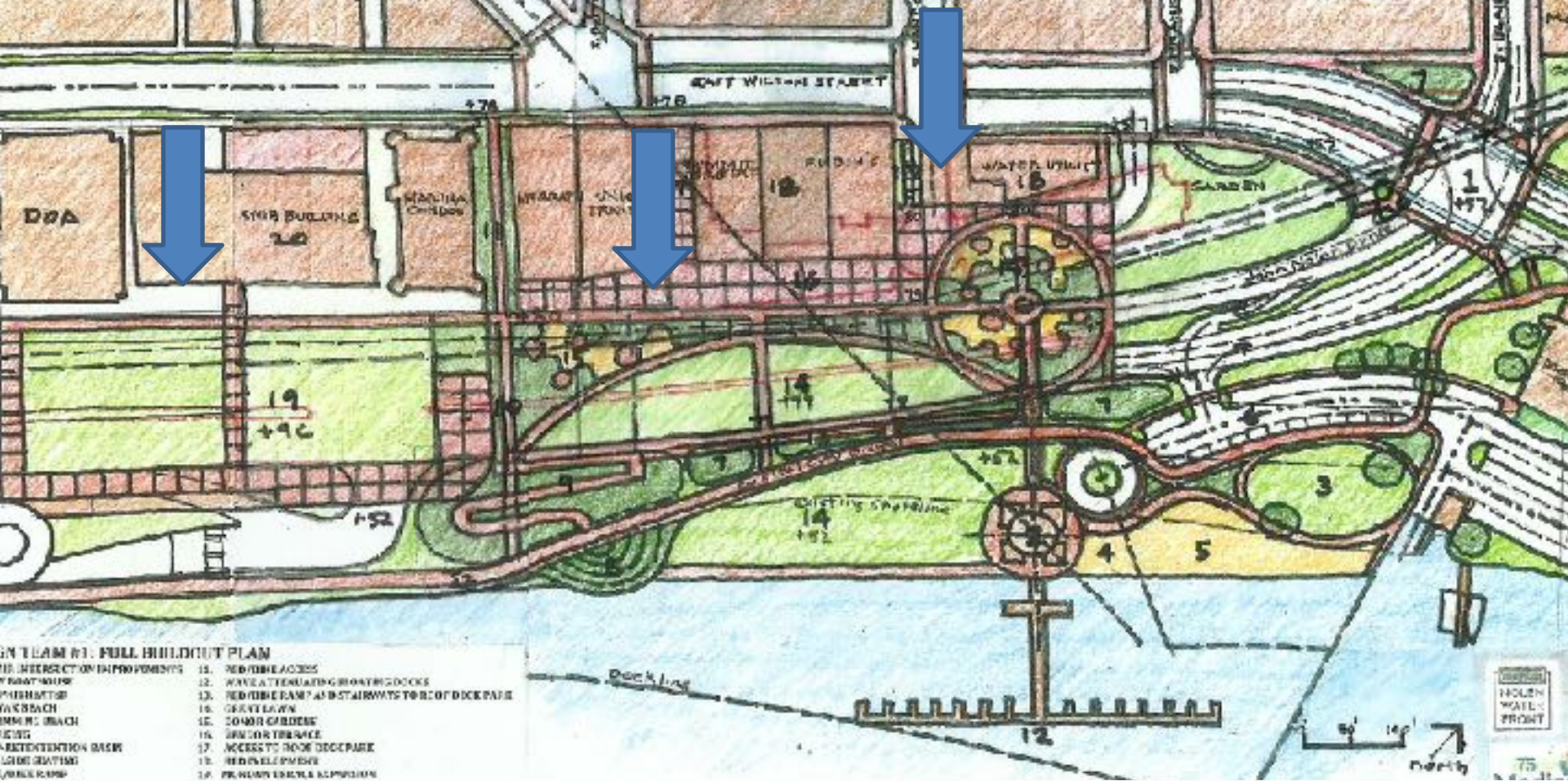

Concept 1 – Phase 2



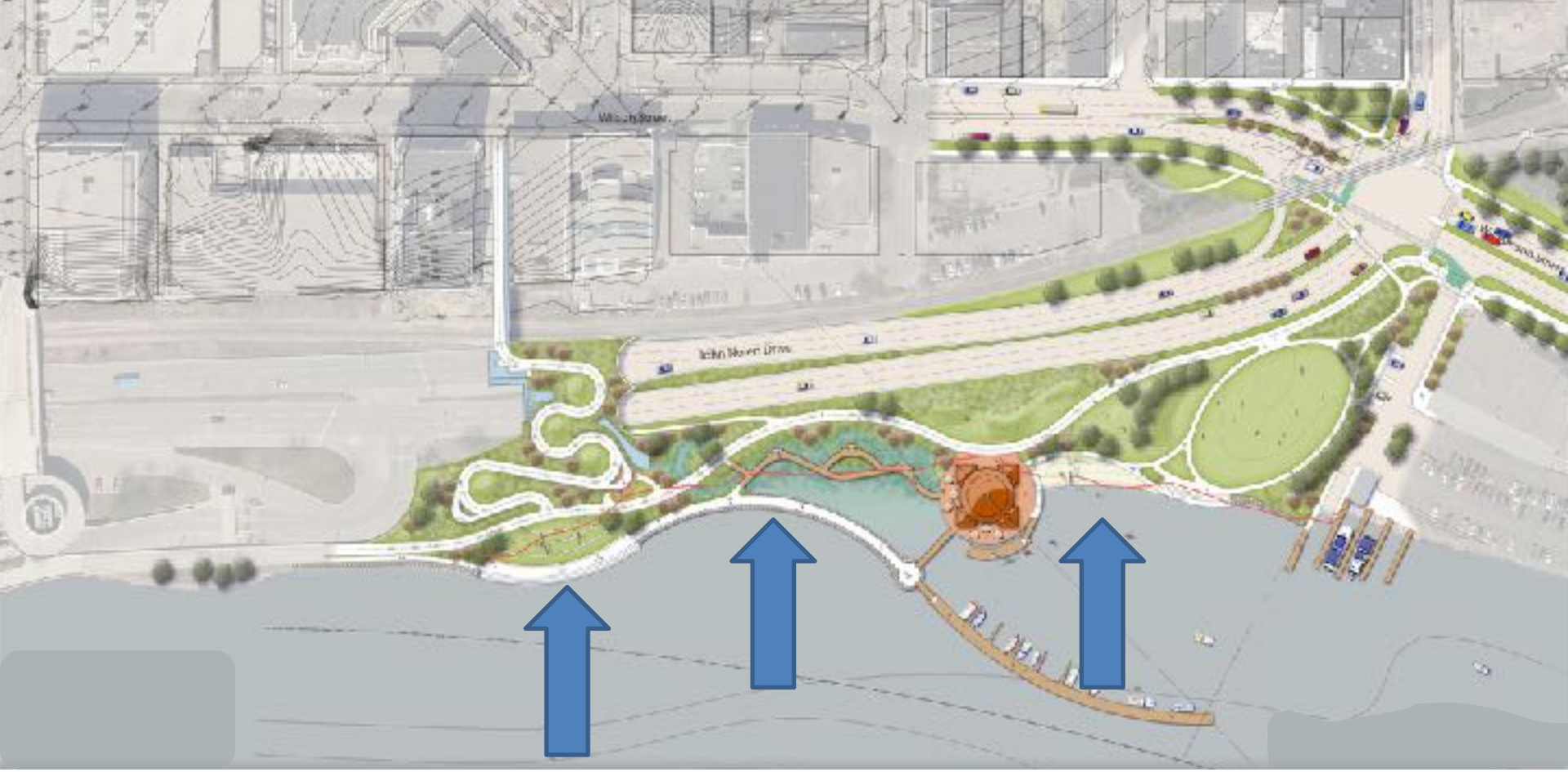

Concept 2 – Phase 1



Concept 2 – Phase 2

Concept 3 Land Bridge

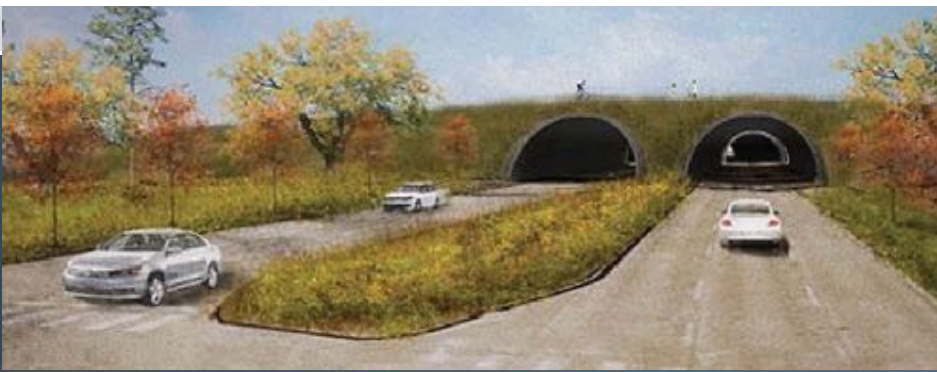

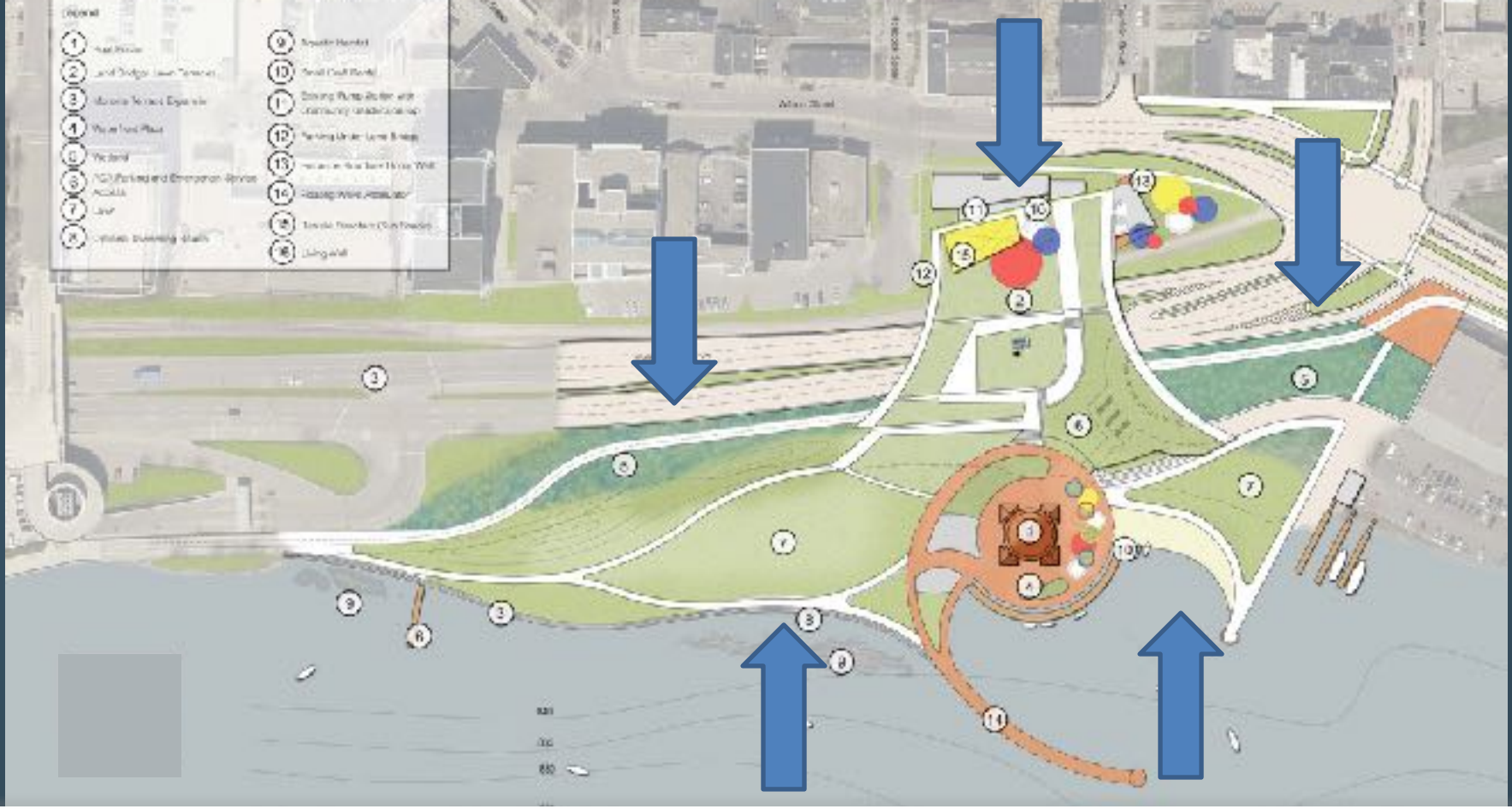

Concept 3 – Phase 1



Concept 3 – Phase 2

Concept 3 Wellands



1

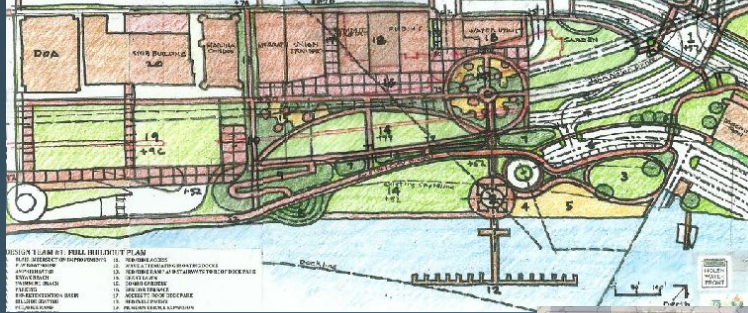

2



3



PHASE 2 ALTERNATIVE CONCEPTS

WHAT WILL THE NOLEN WATERFRONT DO FOR MADISON?

- Best and only place where substantial park land can be provided
- Best way to access the lake easily, safely, and beautifully from Downtown
- Best place for a “Union Terrace” for Madisonians
- Wide range of accessible water activities
- Two Frank Lloyd Wright buildings on the same lakeshore
- Greatly improves a complicated intersection
- Stimulate high quality development
- Great source of civic pride
- Will improve shoreline fishing and water quality

A HEARTWARMING RESPONSE

- **Community leaders**
- **Media coverage**
- **Grant from the Madison Community Foundation**
- **Board support**
- **UW School of Civil and Environmental Engineering**
- **DMI Invitation**

A NEED FOR A MASTER PLAN

- **Greatness requires a plan**
- **Will take 20 years to build**
- **Must be done in phases**
- **Will require many consulting specialties**
- **Will require two years to complete**
- **Should be done between 2018 to 2020**

WANTED: AN EFFECTIVE PUBLIC-PRIVATE PARTNERSHIP

- Similar to Monona Terrace
- Key Private sector roles
 - Leadership
 - Philanthropy













A photograph of a man in a light blue button-down shirt carrying a young girl on his shoulders. The girl is wearing a pink shirt and denim overalls. They are in a crowded outdoor area with many other people in the background, all slightly out of focus. The scene is set against a backdrop of green trees.

our history is waiting...

nolenwaterfront.org